



Mistral Series

Online Double Conversion Technology

1 to 3 KVA - single phase



SOHO



DATA CENTRE



E-MEDICAL



INDUSTRY



TRANSPORT



EMERGENCY



Multifonction : Rack, Tour, Simple & extended (upgradable) back-up time

This UPS series is a single phase in, single phase out high frequency online UPS. It provides four (4) capacities:

The 1, 3, 6 and 10 KVA. These equipments are modularized and adopt the N+1 redundancy. It can flexibly increase the number of the UPS modules according to the load capacity which is convenient for flexible allocation and gradually investment for 6 and 10 KVA only.

The UPS can solve most of the power supply problems, such as blackout, over-voltage, under-voltage, voltage sudden drop, oscillating of decreasing extent, high voltage pulse, voltage fluctuation, surge, inrush current, harmonic distortion (THD), noise interference, frequency fluctuation, etc..



ONLINE DOUBLE CONVERSION TECHNOLOGY



RACK TOUR



USB PLUG



HOT SWAP BATTERY



INPUT PLUG C14



PLUG AND PLAY



LCD SCREEN



REMOTE CONTROL SOFTWARE

This UPS can be applied to different applications from computer device, automatic equipment, communication system to industry equipment.

Standards

- Standards (Surge Suppressions): EN 61000-2-2/ EN 61000-4-2, Level 4/ EN 61000-4-3, Level 3/ EN 61000-4-4, Level 4 (also on signal ports)/ EN 6100-4-5, Level 4 Criteria A
- Standards (EMC Certification): CE per IEC/EN 62040-2/ Class B
- Standards (EMC Emissions): IEC 62040-2:ed2:2005/ EN 62040-2:2006
- Safety conformance: IEC 62040-1-1
- Agency marking: CE

A reliable solution to fulfill to all your needs



1 Rack Tour

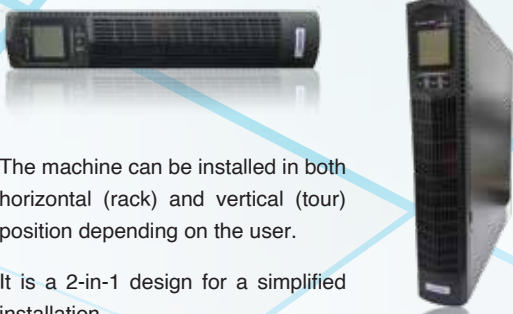

The machine can be installed in both horizontal (rack) and vertical (tour) position depending on the user.

It is a 2-in-1 design for a simplified installation.

2 Rotating display Screen



LCD display rotated 90°

With LCD plus LED displays, the user may easily get UPS status and its operational parameters, such as input/output voltage, frequency & load%, battery % and ambient temperature, etc..

3 Additional Batteries/Battery hot-swap



Hot-Swap battery allows you change battery/ies in a UPS without shutting down the machine.

A maximum of **four (4)** batteries can be added in the UPS (**Plug and Play**)

4 UPS monitoring & Automatic shutdown software



The software is compatible with Novell Netware, Windows 2000/XP/Vista/7, Windows server 2003/2008/2012, Linux, FreeBSD and Mac.

Support SEC Protocol & USB Interface.

5 Intelligent port slots



The use of the SNMP agent, BMS and AS 400 makes it easier in management features such as:

- Setting up and programming extinctions etc..

6 Digital Control



This series UPS is controlled by Digital Signal Processor (DSP); enhance, it increases reliability, performance, self protection, self-diagnostics and so on.

7 Intelligent Charging Method



The series UPS adopts advanced three-stage charging method:

1st stage: High current constant current charging to guarantee to charge back to 90%.

2nd stage: Constant Voltage in order to vitalize battery and make sure batteries are fully charged.

3rd stage: Floating mode, with this 3-stage charging method, it extends the life of the batteries and guarantees fast charging.

8 1Phase In/1Phase Out UPS



It is 1-Phase In/ 1Phase Out high-density UPS system, of which input current is kept in balance.

No unbalance problem might occur. And also support for three phase input.

9 Rails (Options)



4-Post Rack-Mount Installation of Mistrals

- Supports UPS systems in 4-post rackmount applications
- Temporary placement pegs implies single-person installation

10 Emergency Power Off (EPO)



The Emergency Power Off (EPO) button, also called an EPO switch or EPO panel, is a safety measure for quickly disconnecting electrical power to a particular piece of equipment, or to an entire facility, in the event of an emergency.

Mistral 1 KVA



- ① Power ON/OFF button
- ② LCD rotating button
- ③ LCD screen
- ④ Removable grill
- ⑤ USB port
- ⑥ RS232 port



- ⑦ Emergency power off (EPO)
- ⑧ RJ45 Net surge protection
- ⑨ Breaker reset button
- ⑩ Port intelligent slots
- ⑪ Input plug C14
- ⑫ Max 10A segments 6 outputs - C13

Mistral 6 / 10 KVA



- ① Power ON/OFF button
- ② LCD rotating button
- ③ LCD screen
- ④ Removable grill
- ⑤ USB port
- ⑥ Parallel ports
- ⑦ Port intelligent slots



- ⑧ Protocol Data Unit (PDU)
- ⑨ COM
- ⑩ Emergency power off (EPO)
- ⑪ Battery
- ⑫ Breaker switch
- ⑬ Breaker reset button
- ⑭ Max 10A segments 2 outputs - C13

Specifications

DESCRIPTION	MISTRAL 1 KVA	MISTRAL 2 KVA	MISTRAL 3 KVA	MISTRAL 6 KVA	MISTRAL 10 KVA
Capacity	900(W) POOIP1501	1800(W) POOIP1502	2700(W) POOIP1503	5400(W) POOIP1503	9000(W) POOIP1504
INPUT					
Input Voltage	220/ 230/ 240 Vac (P+N+T) ±20%				
Operating frequency range	45 – 55 Hz/ 54 – 66 Hz ± 0.5 Hz				
Input power factor	≥ 0.98		≥ 0.99		
Bypass voltage range	Max voltage.: +15% (optional +15%, +10%, +25%) Min voltage.: -45% (optional -15%, -20%, -30%) Protected frequency range: ±10%		220V ± 25% (optional +10%, +15%, +20% +15% (optional +10%) Min voltage: -45% (optional -20%, -30%)		
Bypass frequency range	± 10%				
Total Harmonic Distortion (THD)	5% (Non linear mode)			≤ 3% (100% Linear mode)	
Generator input	Supported				
OUTPUT					
Output voltage	220/ 230/ 240 Vac (Adjustable)				
Power factor	0.9				
Voltage Regulation	±2%				
Frequency (Online mode)	50 or 60Hz		±1%/ ±2%/ ±4%/ ±5%/ ±10% Rated frequency (optional)		
Frequency (Battery mode)	≤5% (Non linear mode)		50/ 60 (±0.1) Hz		
Crest factor	3:1				
Total Harmonic Distortion (THD)	≤ 2% (Linear mode)/ ≤ 5% (Non linear mode)				
Wave form	Pure Sinewave				
BATTERY					
Typical recharge time	6-8 hours (90% of full capacity)				
Backup time at 80%	No. of batt	2	4	6	External batteries (Ext. batt - Max 4 units)
	Time	10 min	10 min	10 min	
	No. of ext batt & time	4 / +20 min	8 / +20 min	12 / +20 min	
Charge current	Max current: 10A, charge current can be set according to battery capacity installed				
SYSTEM FEATURES					
Transfer time	Utility to battery: 0ms – Utility to bypass: 0ms				
Overload (Linear mode)	Load (≤110% last 60min/ ≤125% last 10min/ ≤150% last 1sec/ >150% turn back to bypass mode				
Overload (Battery mode)	10A input breaker	15A input breaker	20A input breaker	40A input breaker	60A input breaker
Short circuit	Hold whole system				
Overheat	Line mode: switch to bypass – Backup mode: switch down the UPS immediately				
Low battery voltage	Alarm and switch OFF				
Self diagnostic	Upon power ON and software control				
Battery	Advanced (smart) battery management				
Noise suppression	Complies with EN62040-2				
Audible & visual alarms	Line failure, battery low, Overload, system fault				
Status Led & LCD display	Line mode, backup mode, ECO mode, Bypass mode, Battery low, Battery bad, Overload & UPS fault				
Reading on the LCD display	Input voltage, Input frequency, Output voltage, Output frequency, Load percentage, Battery voltage, Inner temperature & Remaining battery back-up time				
Communication interface	USB, RS232, Parallel port, SNMP card, Relay card (optional)				
ENVIRONMENT					
Operating temperature	0 - 40 °C				
Storage temperature	-25 °C – 55 °C				
Humidity range	0 – 95% (non condensing)				
Altitude	<1500m				
Noise level	<55dB				
PHYSICAL					
Dimensions (L x H x P) mm	440 x86.5 x 430 (2U)	440 x 86.5 x 696 (2U)	443 x 131 x 580 (3U)		
Weight (Kg)	12	32	56	62	
Security	IEC/ EN62040 – 1 IEC/ EN60950 – 1				
EMC	IEC/EN62040-2,IEC6100-4-2,IEC6100-4-3,IEC6100-4-4,IEC6100-4-5, IEC6100-4-6,IEC6100-4-8				



Ipower International Ltd

BPML Freeport Zone 6, Mer Rouge, Republic of Mauritius

+230 5 988 90 80 / +230 5 940 92 68

+230 5 956 33 00

sales@ipower.re / info@ipower.re

www.ipower.re

- Uninterruptible Power Supply (UPS)
- Automatic Voltage Regulator (AVR)
- Isolating Transformers Maintenance free
- 12VDC VRLA batteries manufacturer
- Distributor, installer & service provider

BRN: C15131905
VAT: 27357325